

## INSTALLATION INSTRUCTIONS PPC - PLASTIC PIPE COLLAR

INSTALLATION

**Step # 1** Ensure annular space around pipe is within the limits set by the listed system design. If required, caulk annular space around pipe with 3600EX or 4800DW as prescribed in the listed system design. Select the proper size collar to fit the diameter of the pipe. Slide PPC Collar flush against the underside of the floor assembly or the side of the wall assembly and close the collar around the pipe using the clasp.

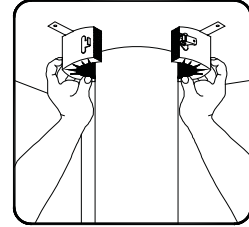

**Step # 2** Secure the PPC Collar to the floor or wall by mechanically fastening the correct number of anchoring tabs with appropriate type of fastener specified in the listed system design.

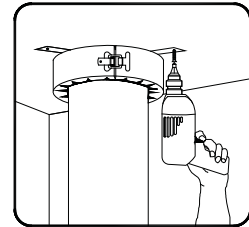

**Step # 3** When installing PFPP's PPC collar on wall applications, a collar must be installed on each side of the wall

